

2

1

B

B

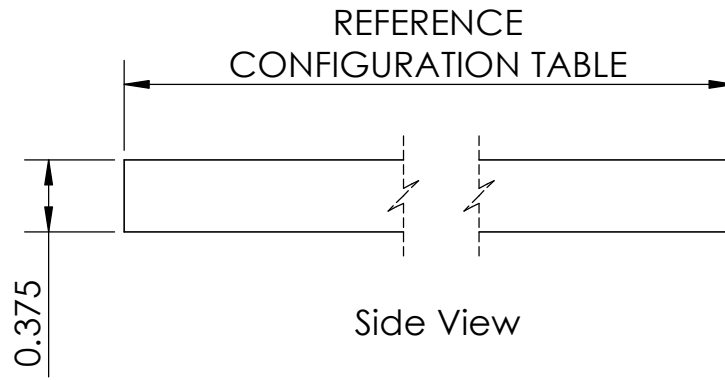
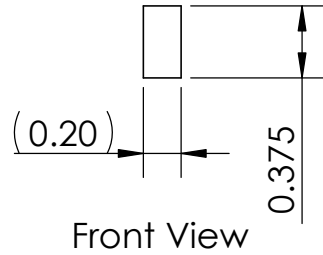
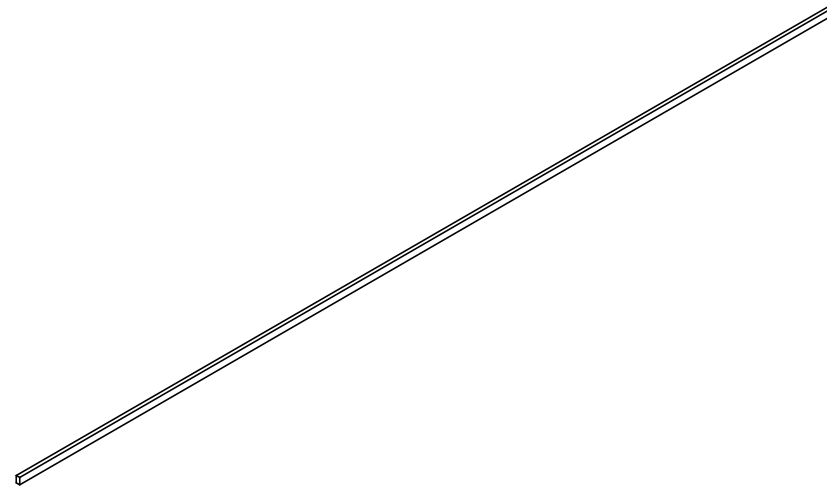
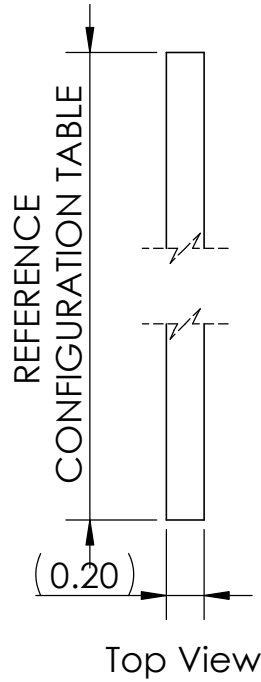

A

A

CONFIGURATION TABLE		
SKU	LENGTH	WEIGHT (lbs)
ALL-ROD-48-NP	48"	0.20
ALL-ROD-94-NP	94"	0.39

SPAN CARBON FIBER
STRUCTURAL SOLUTIONS

UNLESS OTHERWISE SPECIFIED:
DIMENSIONS ARE IN INCHES
TOLERANCES:
FRACTIONAL: ±1/8"
ANGULAR: ±5°
TWO PLACE DECIMAL: ±0.05
THREE PLACE DECIMAL: ±0.005

PROPRIETARY AND CONFIDENTIAL
THE INFORMATION CONTAINED IN THIS DRAWING IS THE SOLE PROPERTY OF CF SPAN LLC. ANY REPRODUCTION IN PART OR AS A WHOLE WITHOUT THE WRITTEN PERMISSION OF CF SPAN LLC. IS PROHIBITED.

	NAME	DATE
DRAWN	SH	4/7/25
CHECKED	ER	4/7/25
ENG APPR.	DL	4/7/25
MFG APPR.		
Q.A.		
COMMENTS:		

CF CARBON BAR™
HIGH STRENGTH - LIGHT WEIGHT

TITLE:
COUNTERTOP RODDING

SIZE A	DWG. NO. ALL-ROD-XX-NP	REV 1
------------------	---------------------------	-----------------

SCALE: 1:8 WEIGHT: SHEET 1 OF 2

2

1

2

1

B

B

REFERENCE CONFIGURATION TABLE

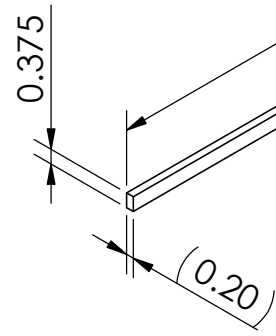

A

A

CONFIGURATION TABLE		
SKU	LENGTH	WEIGHT (lbs)
ALL-ROD-48-NP	48"	0.20
ALL-ROD-94-NP	94"	0.39

SPAN CARBON FIBER
STRUCTURAL SOLUTIONS

PROPRIETARY AND CONFIDENTIAL
THE INFORMATION CONTAINED IN THIS DRAWING IS THE SOLE PROPERTY OF CF SPAN LLC. ANY REPRODUCTION IN PART OR AS A WHOLE WITHOUT THE WRITTEN PERMISSION OF CF SPAN LLC, IS PROHIBITED.

UNLESS OTHERWISE SPECIFIED: DIMENSIONS ARE IN INCHES TOLERANCES: FRACTIONAL: ±1/8" ANGULAR: ±5° TWO PLACE DECIMAL: ±0.05 THREE PLACE DECIMAL: ±0.005		
DRAWN	SH	4/7/25
CHECKED	ER	4/7/25
ENG APPR.	DL	4/7/25
MFG APPR.		
Q.A.		
COMMENTS:		

CF CARBONBAR™
HIGH STRENGTH - LIGHT WEIGHT

TITLE:
COUNTERTOP RODDING

SIZE	DWG. NO.	REV
A	ALL-ROD-XX-NP	1

SCALE: 1:4 WEIGHT: SHEET 2 OF 2